

Stalybridge HSHAZ – Heritage Walk

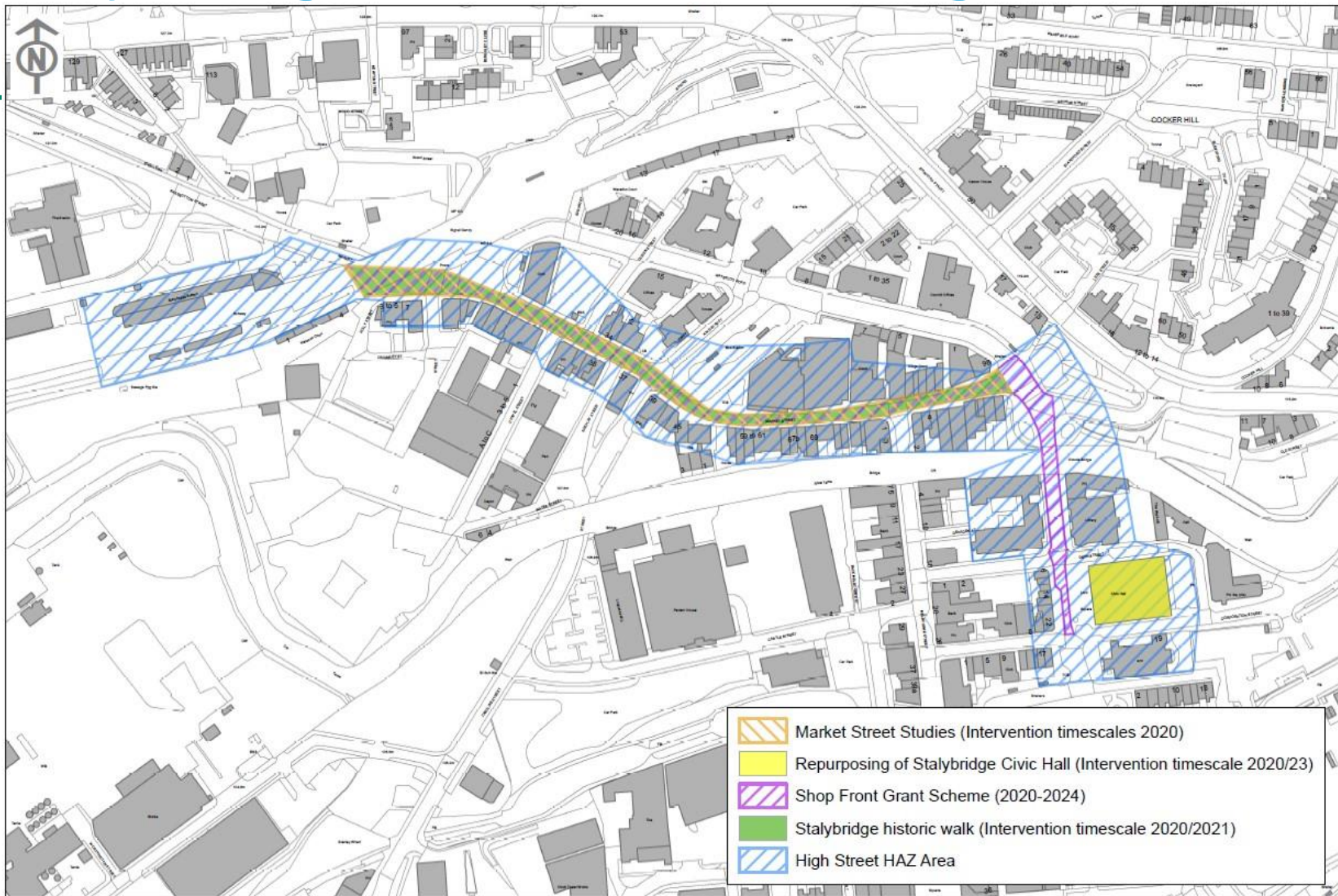

© Crown copyright and database rights 2019 Ordnance Survey 100022697

0 0.05 0.1 0.2 Miles

Scheme details

- The Heritage Walk scheme has been designed to reflect the current situation with regards to materials, achieve best value and secure maximum benefit for the wider HSHAZ scheme and Stalybridge Town Centre.
- We have worked to engage and take onboard the advice from Historic England; including from their Landscape Architect for the North of England who has provided positive feedback on the approach TMBC has taken in respect of scheme design.
- Several engagement exercises have resulted in changes to the scheme design to suit the businesses and community of Stalybridge.

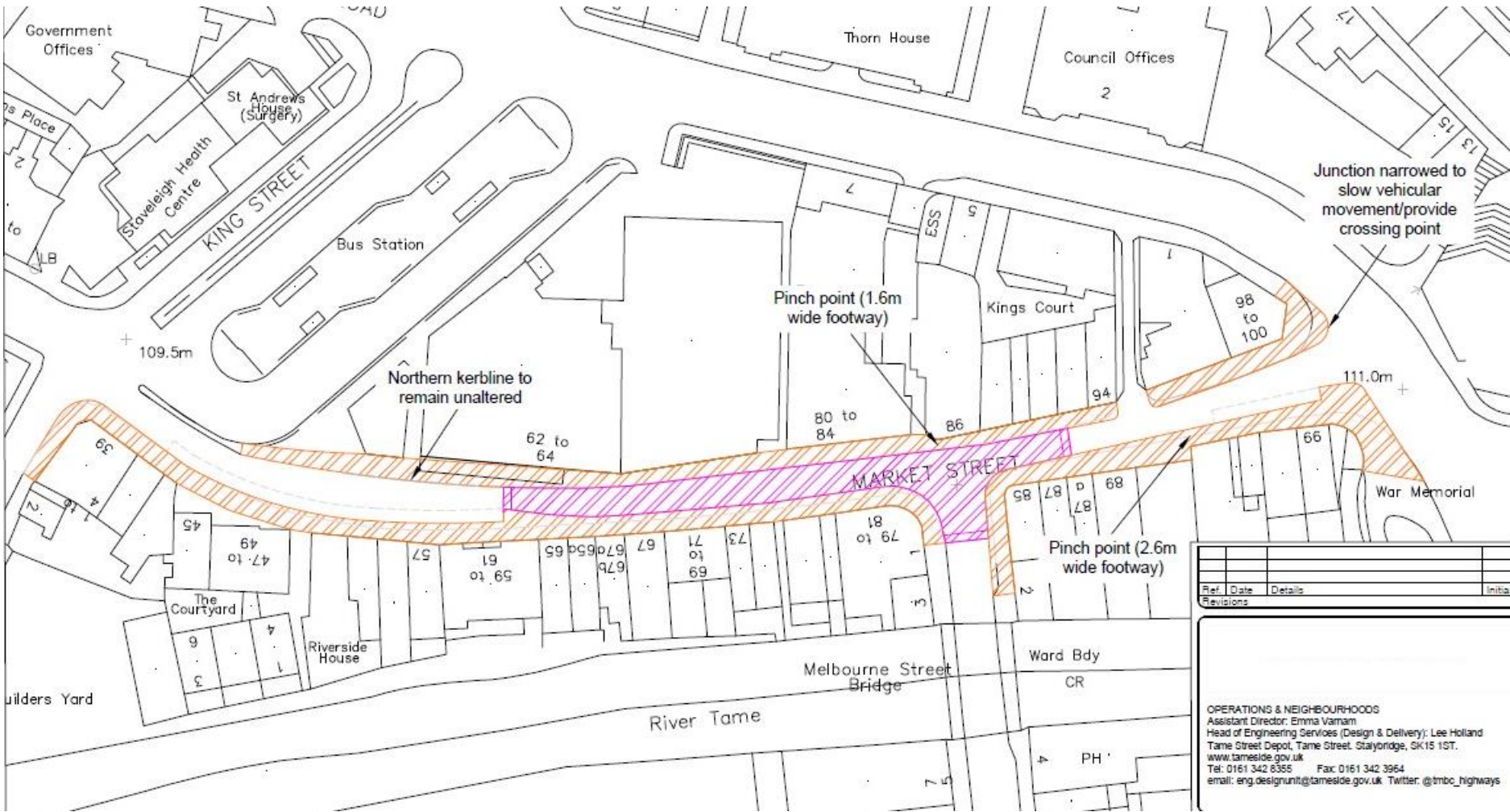

Ref.	Date	Details	Initials

OPERATIONS & NEIGHBOURHOODS
 Assistant Director: Emma Varnam
 Head of Engineering Services (Design & Delivery): Lee Holland
 Tame Street Depot, Tame Street, Stalybridge, SK15 1ST.
 www.tameside.gov.uk
 Tel: 0161 342 8355 Fax: 0161 342 3964
 email: eng.designunit@tameside.gov.uk Twitter: @tmbc_highways

Scheme Design

- The proposed scheme now provides wider pavements, safer walking routes, reduced vehicle speeds and improved accessibility.
- The Trinity Street junction is proposed to be narrowed
- The southern side pavement widened to enhance pedestrian routes.
- The area around the Melbourne Street junction designed as a raised surface to further improve pedestrians movements and reduce traffic speeds.
- There will be space for benches, cycle racks and outdoor tables and chairs and planters
- Decluttering to remove of bollards, sign posts and develop options for housing wheelie bins.
- Net loss of up to 2 parking bays to accommodate the increased pavement width.
- Servicing and loading for properties will be able to continue.
- Work to investigate and seek resolution with bins on the highway.

Traffic Regulation Order – Market Street

Approved September 2022 following engagement events and public consultation

No Waiting at Any Time restrictions on Market Street:

- north side - from its junction with Waterloo Road to its junction with Water Street
- south side - from its junction with Waterloo Road for a distance of 10 metres in a westerly direction
- south side - from a point 25 metres west of its junction with Waterloo Road to a point 70 metres east of Water Street
- south side - from its junction with Water Street for a distance of 15 metres in an easterly direction

Limited Waiting, Monday – Saturday, 8-6, 1 hour, no return within 2 hours on Market Street

- south side - from a point 10 metres west of its junction with Waterloo Road for a distance of 15 metres in a westerly direction
- south side - From a point 70 metres east of its junction with Water Street for a distance of 55 metres in an easterly direction

Artists Impression



Artists Impression

